



Kinetics Controls & Innovation Ltd

Case History

UK Land Well Drilling & Completions Tubing Hanger Isolation

Tubing body hanger damage, may have transferred to the tubing bowl, issues with obtaining an Isolation.

Body and neck seals will be replaced for new. Indications are that it is only the body sealing area is in question.

The object is to provide a process with product and tooling as a contingency in support of this application

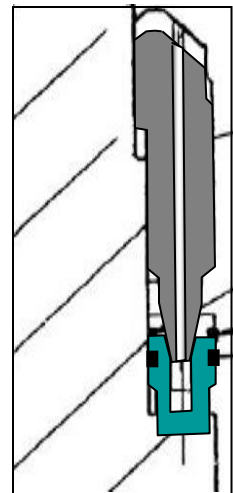
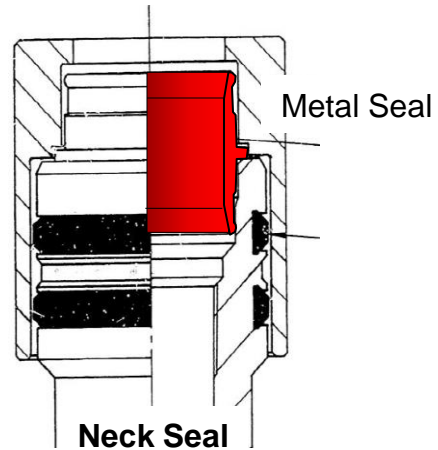
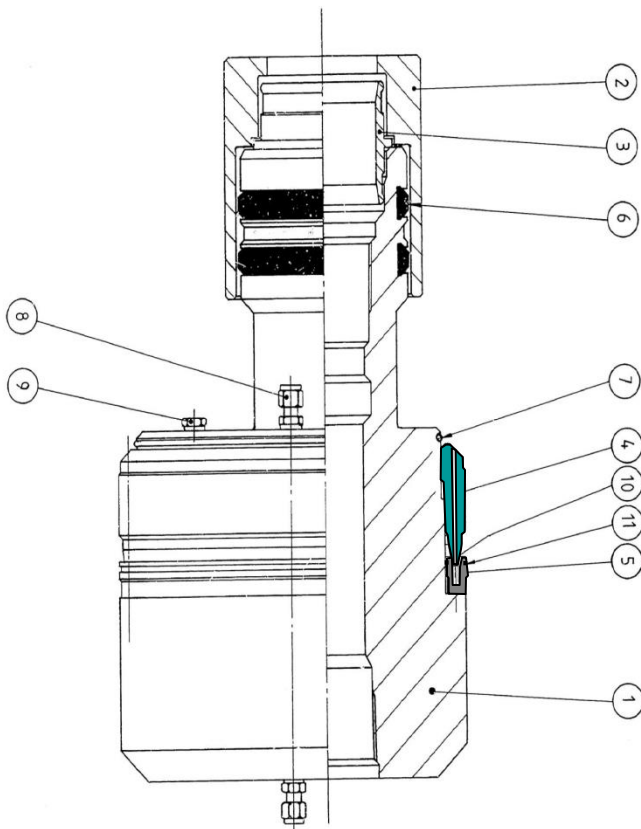

Hanger Body Seal



Kinetics Controls & Innovation Ltd

Evaluation:

Bleed / vent Annulus and production string

Neck Seal:

Sting the void test port

Inject light oil in through the neck seal test port and build up to test pressure

Monitor any test fluid displacement through the void test port.

Report findings

Void:

Sting the Neck Seal test port.

Inject light oil in through the void test port and build up to test pressure

Monitor any test fluid displacement through both neck seal and body test ports.

Report findings.

This will support curing, leak path and sealant displacement times

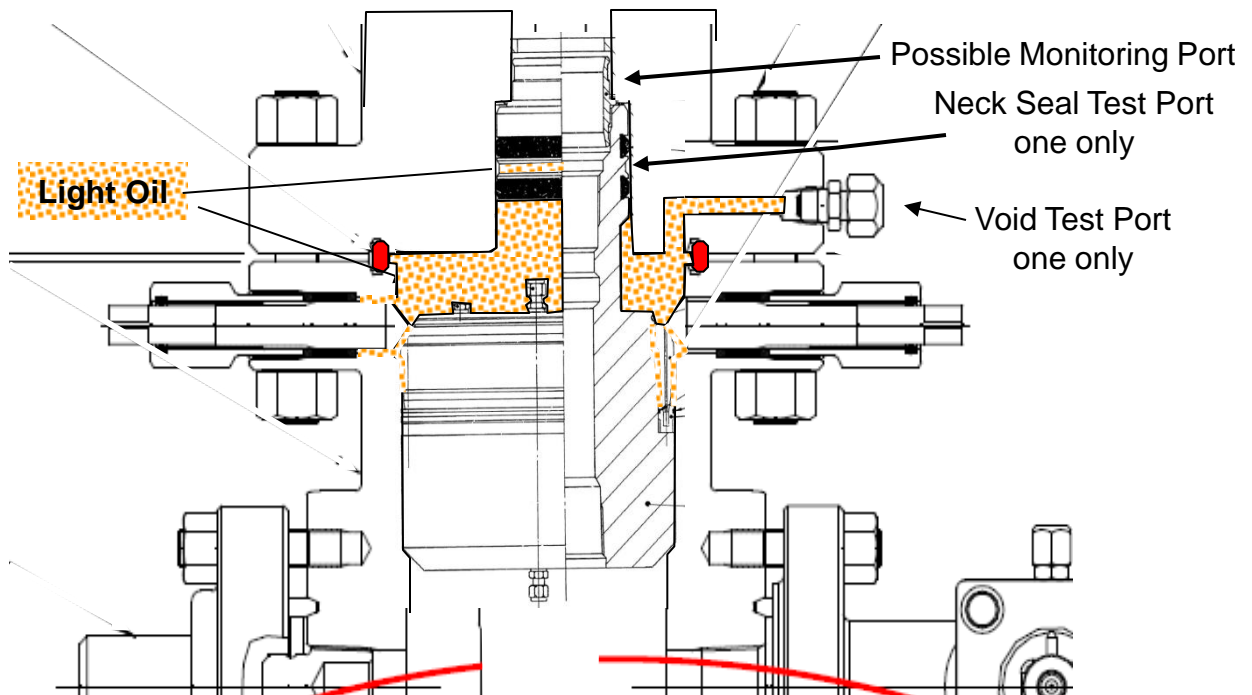



Kinetics Controls & Innovation Ltd

Sealant Deployment: Curing Time , 2 to 3 hours (subject to deployment temperature).

Bleed / vent Annulus and production string

Void: Hanger Body & Lockdown Screws Isolation Issues (Void Part Fill).

Sting the Neck Seal test port and Body test port

Inject Mac-Seal 02 (3Litres) in through the void test port.

Inject 100mls of grease to displace the sealant followed by (3Litres T.B.C.) of light oil

Testing: Pressure test through void test port

